

How Do I Place IE11 in Compatibility Mode

With the recent upgrade to windows 8.1 and the new version of Internet Explorer that Microsoft released, PrePass.com users must run IE11 in compatibility mode to properly function. Below is a step by step process on how to set your browser to compatibility mode.

1. Navigate to www.prepass.com . Once on the PrePass website go to your browser tools menu and select **Compatibility View Settings**.

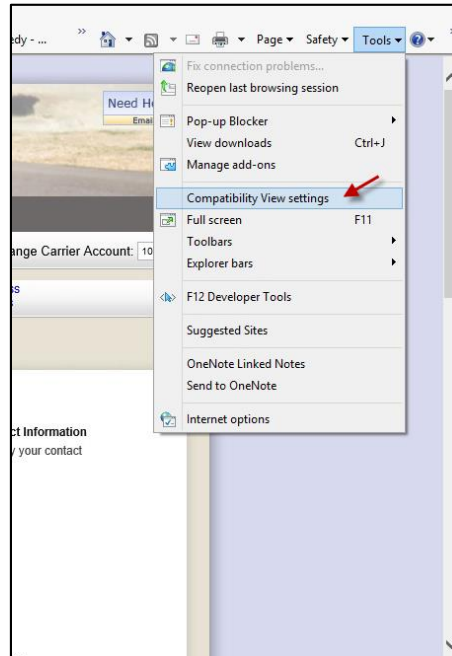

2. When the compatibility pop up window appears, you will see prepass.com prefilled in the **Add this website** field. Click the add button and then click the close button. The page should reload and adjust to compatibility mode.

